



Optional Case

Description & Features:

- Highly accurate: $\pm 0.25\%$ for 6" (150mm), $\pm 0.50\%$ for 4" (100mm) complete with calibration certificate traceable to NIST standards
- Mirrored anti-parallax dial
- Knife-edge pointer
- Protective carrying and storage case available
- CRN registered
- 5 year warranty

Applications:

- Designed to be used where accuracy and repeatability are of prime importance
- Used in laboratories and instrument testing facilities

Specifications	
Dial	4" (100mm), 6" (150mm) white aluminum dial with black markings Both dials have mirror band for precise instrument readings
Case	AISI 304 SS
Lens	Polycarbonate
Ring	AISI 304 SS
Socket	4" (100mm): Brass 6" (150mm): AISI 316 SS
Connection	1/4" NPT or 1/2" NPT standard, bottom
Bourdon Tube	4" (100mm): Brass tube 6" (150mm): AISI 316 SS
Movement	4" (100mm): Brass 6" (150mm): AISI 304 SS temperature compensated
Pointer	Aluminum, anodized black, micrometer adjustable, knife-edge
Welding	Silver alloy
Over-Pressure Limit	30% of full scale value
Working Pressure	Maximum 75% of full scale value
Calibration Conditions	68°F ($\pm 5.4^\circ\text{F}$), 20°C ($\pm 3^\circ\text{C}$) for ambient and process temperatures at atmospheric pressure
Ambient/Process Temperature	-4°F to 150°F (-20°C to 65°C)
Accuracy	4" (100mm): $\pm 0.5\%$ ANSI/ASME Grade 2A 6" (150mm): $\pm 0.25\%$ ANSI/ASME Grade 3A
Enclosure Rating	IP65

Order Codes (products in bold are normally in stock)

Dial Size	4" (100mm)	6" (150mm)	4" (100mm)	6" (150mm)
Tube	Brass Tube	316 SS	Brass Tube	316 SS
Movement	Brass	304 SS temperature compensated	Brass	304 SS temperature compensated
Connection	1/4" Bottom	1/4" Bottom	1/2" Bottom	1/2" Bottom
30" Hg Vacuum/kPa	PTG3999	PTG1999	-	PTG2055
0-15 psi/kPa	PTG4000	PTG2000	-	PTG2056
0-30 psi/kPa	PTG4001	PTG2001	-	PTG2057
0-60 psi/kPa	PTG4002	PTG2002	-	PTG2058
0-100 psi/kPa	PTG4003	PTG2003	-	PTG2059
0-160 psi/kPa	PTG4004	PTG2004	-	PTG2060
0-200 psi/kPa	PTG4005	PTG2005	-	PTG2061
0-300 psi/kPa	PTG4006	PTG2006	-	PTG2062
0-400 psi/kPa	PTG4007	PTG2007	-	PTG2063
0-600 psi/kPa	PTG4008	PTG2008	-	PTG2064
0-1,000 psi/kPa	-	PTG2016	PTG4009	PTG2009
0-1,500 psi/kPa	-	PTG2017	PTG4010	PTG2010
0-2,000 psi/kPa	-	PTG2018	PTG4011	PTG2011
0-3,000 psi/kPa	-	PTG2019	PTG4012	PTG2012
0-5,000 psi/kPa	-	PTG2053	PTG4013	PTG2013
0-10,000 psi/kPa	-	PTG2054	PTG4014	PTG2014

Option suffix for above order codes only:

TG4 = 4" Test Gauge case

4BF = 4" back flange

4FF = 4" front flange

4UC-P = 4" U-Clamp premium

Other ranges and connections sizes available upon request

0.10% accuracy available on request

Add the suffix "B" for back connection

TG6 = 6" Test Gauge case

6FF = 6" front flange

6BF = 6" back flange

4" Bottom with Back Flange

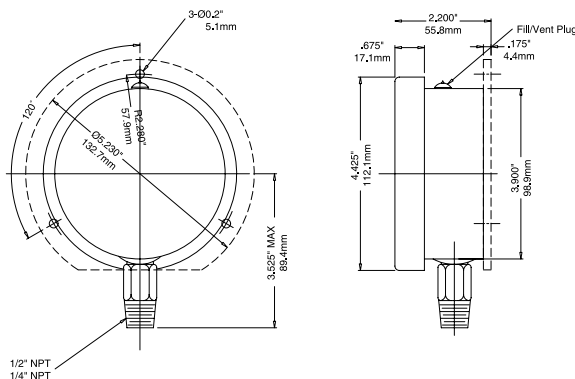

6" Bottom with Back Flange

